

Ex-Employee Portal

Help file

Contents-

1. Steps for new registration
2. Steps to login for existing users
3. Steps for forgot password

Steps for new registration:



Enter Employee Code

Enter Email ID

Enter Mobile Number

(Mobile number as filled in Address for future correspondence form)

Click on Signup

(After clicking on Sign up you will get an OTP on your registered mobile number and Email ID)

* Godrej SMS * Godrej-Ex Employee OTP is 127044. Regards, Godrej & Boyce Mfg. Co. Ltd.

...e OTP is 652749.

...your Account on Ex-Employee Portal.

Verify OTP provided

Create new password as per the guidelines Once OTP is verified

You will get a confirmation message as "Account created successfully"

Now you can login using the credentials.

Caution:-

If mobile number or email ID is entered incorrectly: If either of the email ID or mobile number is entered incorrectly then a new field will open to fill in the PAN card number. Once the correct PAN card details are filled the user can go ahead with the registration.

02.

Steps to login for existing users

Godrej

The screenshot shows the Godrej login interface. At the top left is the Godrej logo. Below it, there are two tabs: 'Login' (selected) and 'New Registration'. The main form contains two input fields: 'Employee Code' and 'Password'. Below the password field is a 'Forgot Password' link and a blue 'Login' button. The background features a collage of colorful icons including a person, a rupee symbol, an envelope, and a bell. Three red arrows point from text boxes to the form: one to the Employee Code field, one to the Password field, and one to the Login button.

Enter Employee code

Enter the Password

Login New Registration

Employee Code

Password

Forgot Password

Login

Click on Login

Steps for forgot password

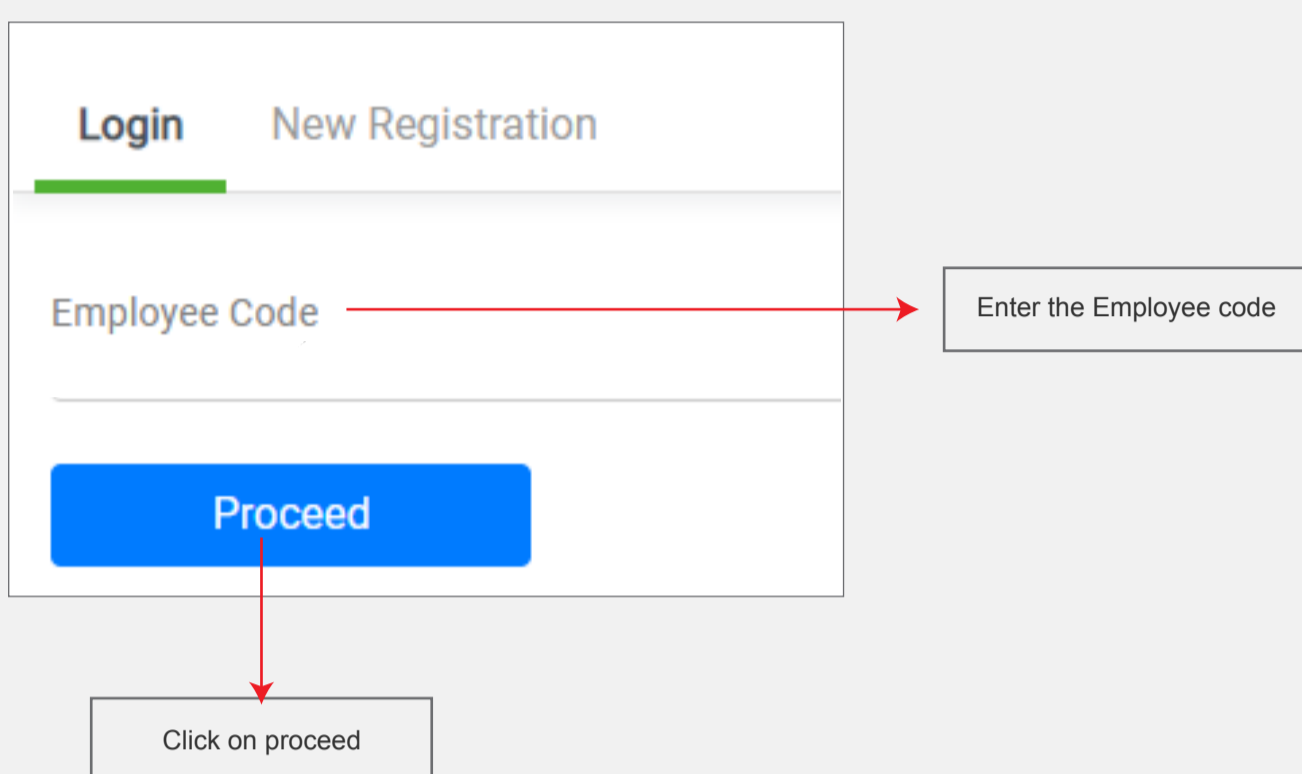
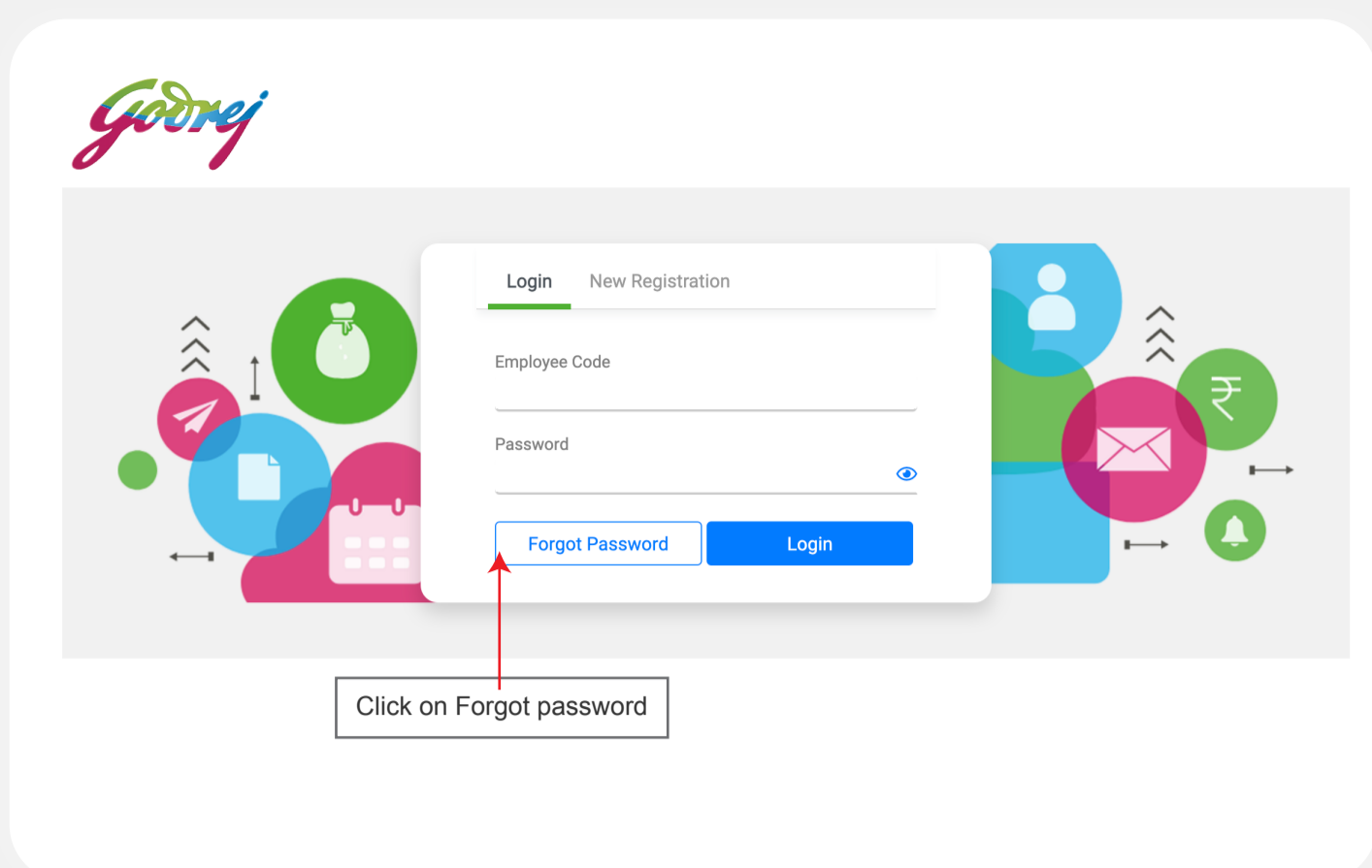

Verify the OTP by entering the OTP provided on registered email ID and Mobile number in Verify OTP screen.

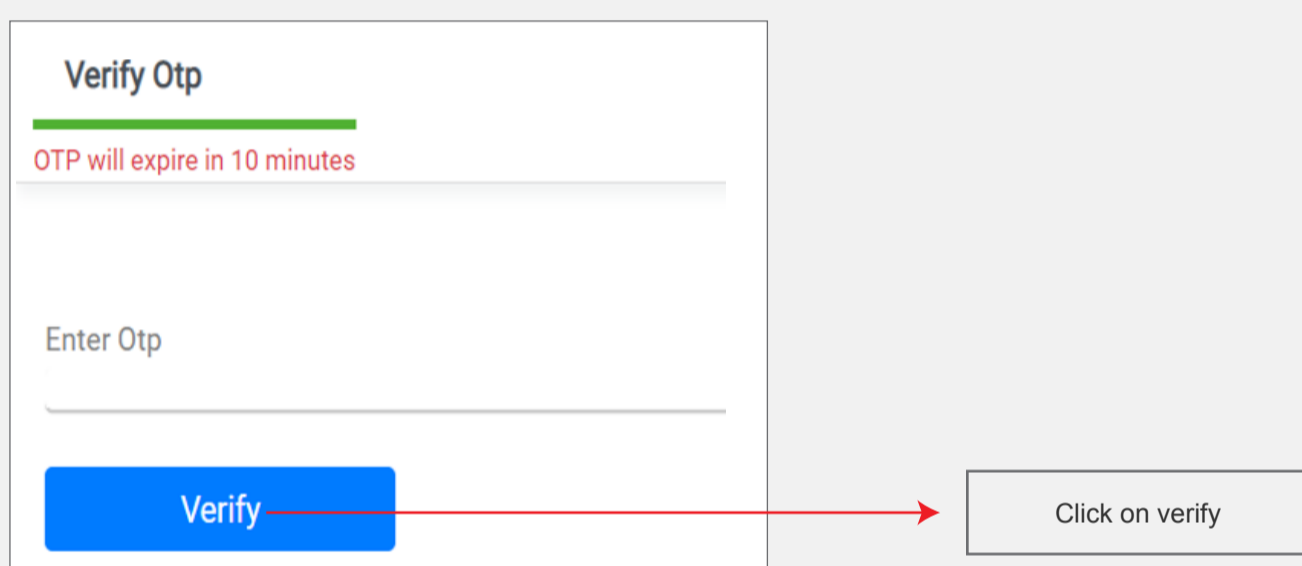

Set new password as per the password policy, by inserting the desired password and confirming the same.

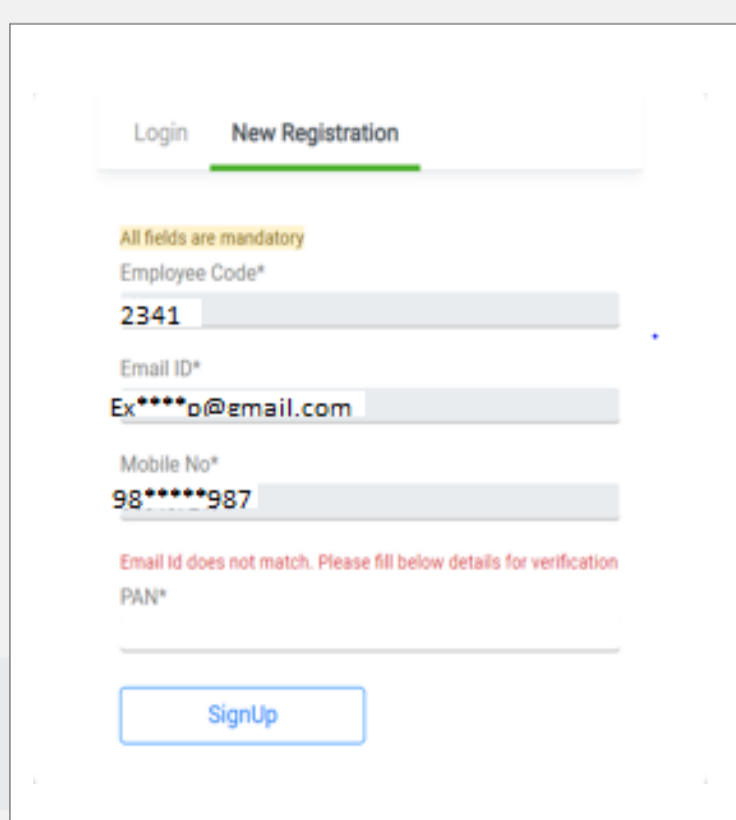
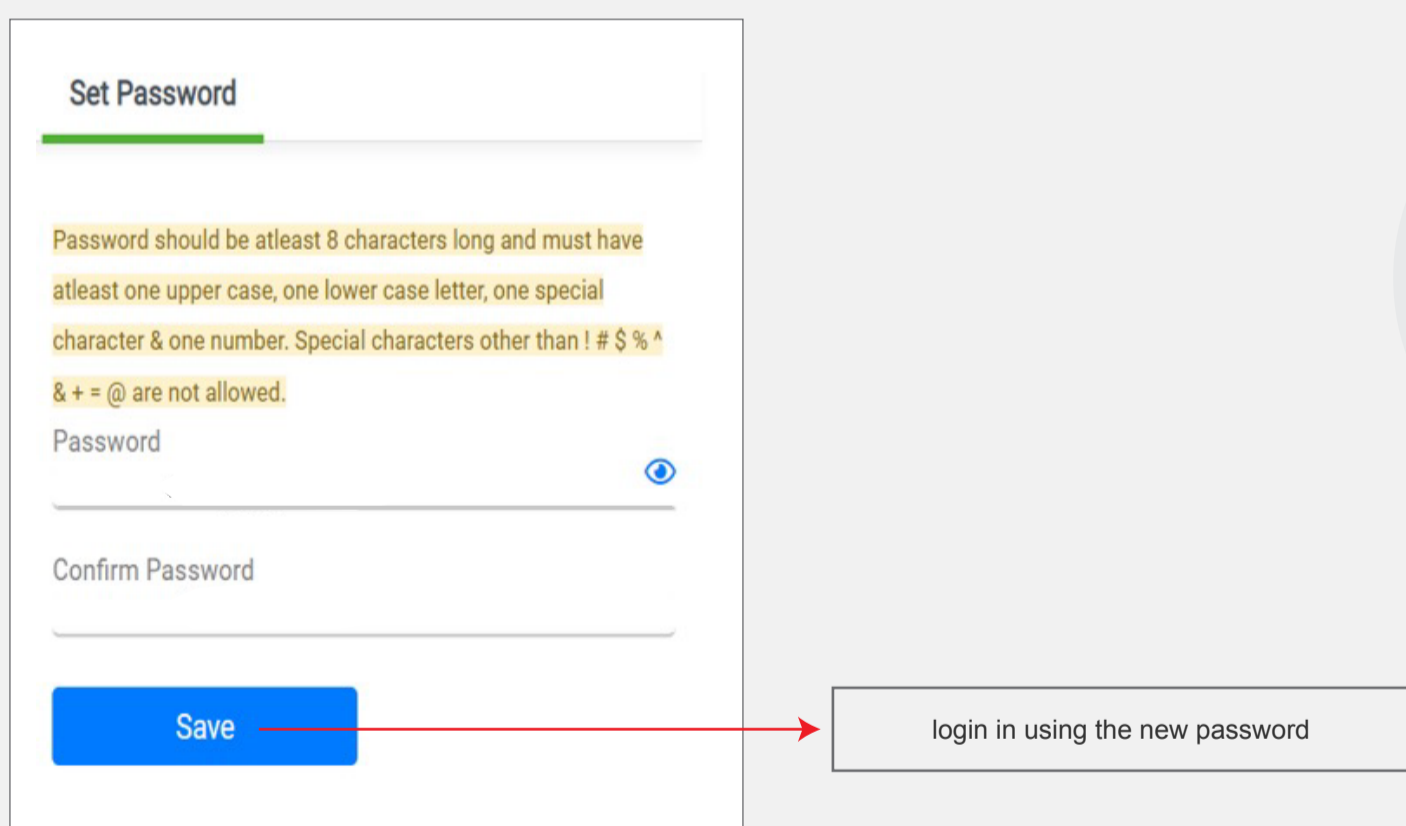

If OTP is entered incorrectly: If the OTP is entered incorrectly thrice while doing new registration, The ID will get blocked; The user can retry after 15 minutes.